

Spare parts catalog for "H crane"

To avoid errors, when ordering please specify:

- Complete type of hoist
- Date of manufacture and serial number
- Spare part code
- Spare part designation
- Additional information

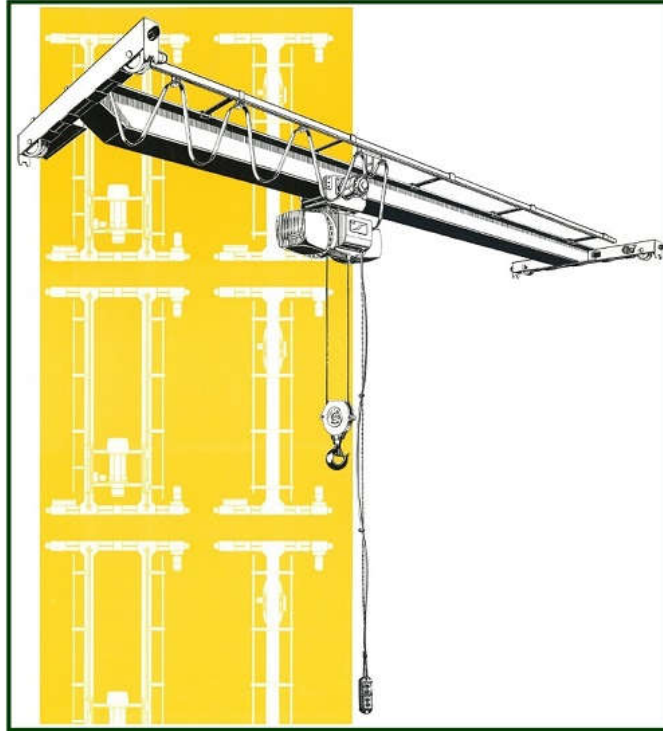

- 1) WHEEL Ø 250
- 2) MOTORGARBOXES
 - 2.1) DC1
- 3) GEARBOXES
- 4) ELECTRICAL EQUIPMENT

1) Wheel Ø 250

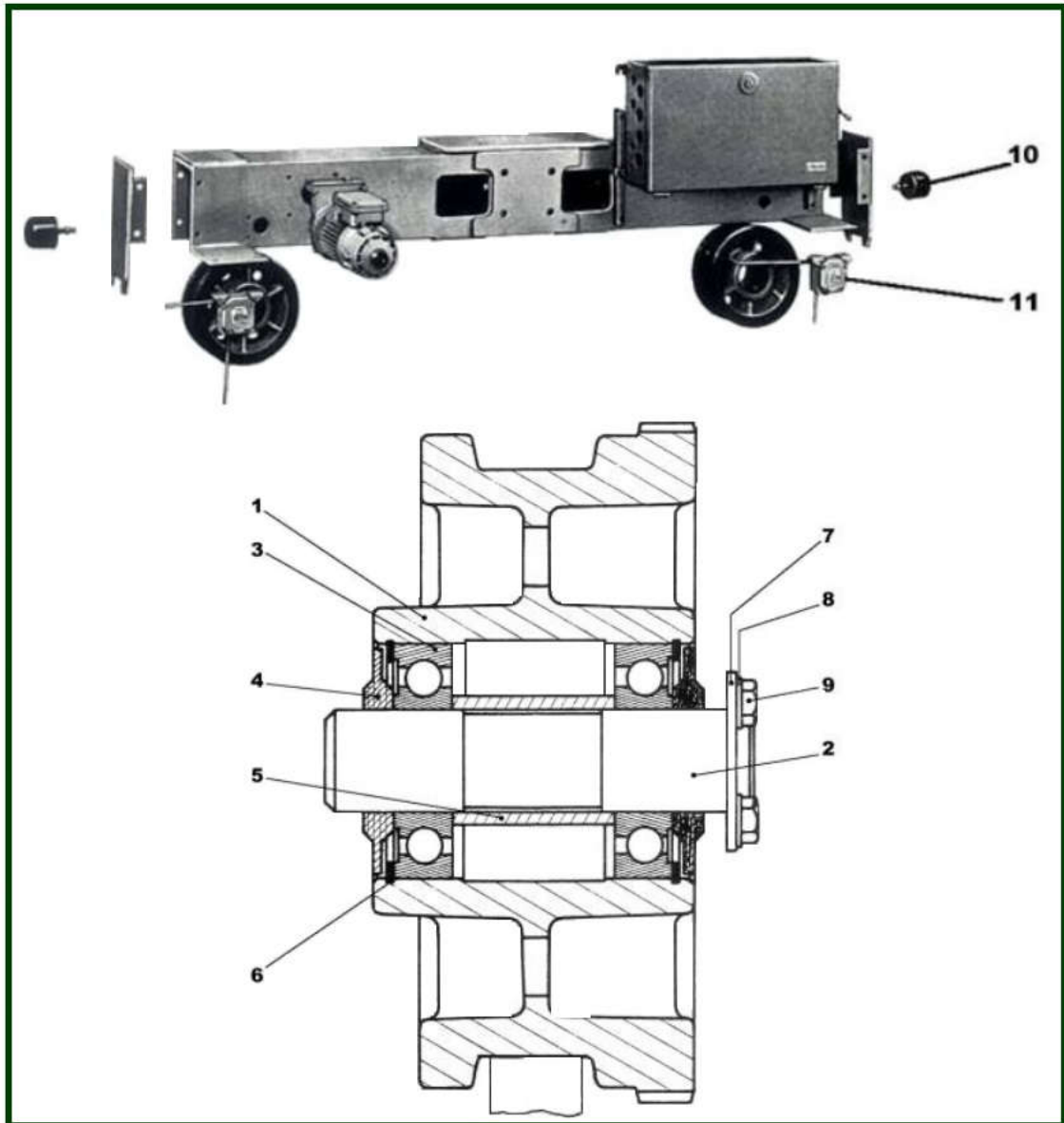

item	reference	description	observation	Quantity
1	5842023A	Driven runner heat treated - G 50 mm	Ø 250 mm - Equipement galet traité / Treated wheel	2
1	5842024B	Driven runner heat treated - G 60 mm	Ø 250 mm - Equipement galet traité / Treated wheel	2
1	5842021Y	Geared wheel - G 50 mm	Ø 250 mm	2
1	5842022Z	Geared wheel - G 60 mm	Ø 250 mm	2
1	5842013Q	Idler runner heat treated - G 50 mm	Ø 250 mm - Equipement galet traité / Treated wheel	2
1	5842014R	Ungeared treated wheel - G 60 mm	Ø 250 mm - Equipement galet traité / Treated wheel	2
1	5842011N	Ungeared wheel - G 50 mm	Ø 250 mm	2
1	5842012P	Ungeared wheel - G 60 mm	Ø 250 mm	2
2	5842032K	Heat treated wheel shaft	Ø 45 mm - Equipement galet traité / Treated wheel	4
2	5842031J	Wheel axle	Ø 45 mm	4
3	7413091H	Bearing		8
3	7424090P	Bearing ball joint	Equipement galet traité / Treated wheel	8
4	5842042W	Shouldered Collar		8
5	5842033L	Ring - 47x57x70		4
5	5842034N	Spacer collar - 47x57x70	Equipement galet traité / Treated wheel	4
6	300081	Interior circlip	D & DA & RD - 100 I	8
7	5841041H	Stop plate		4

8	<u>7232100D</u>	Narrow Grower washer -10mm	DIN12	2
9	<u>7211553V</u>	HM screw 10 x 16	Avant / Before 1980	2
10	<u>VT0001033</u>	Buffer	80x68 - D2240 - B - Sommier / End carriage GT A partir / From H0315168	4
11	<u>7541312D</u>	Travel limit switch	C1-C2-C3	1
12	<u>7661105P</u>	Earth brush	150 amp.	2

2) Motorgearboxes

Br : Bride / Fl : Flange - BA : Bout d'arbre / OS : Output Shaft - PA Pignon d'attaque - DP Drive Pinion

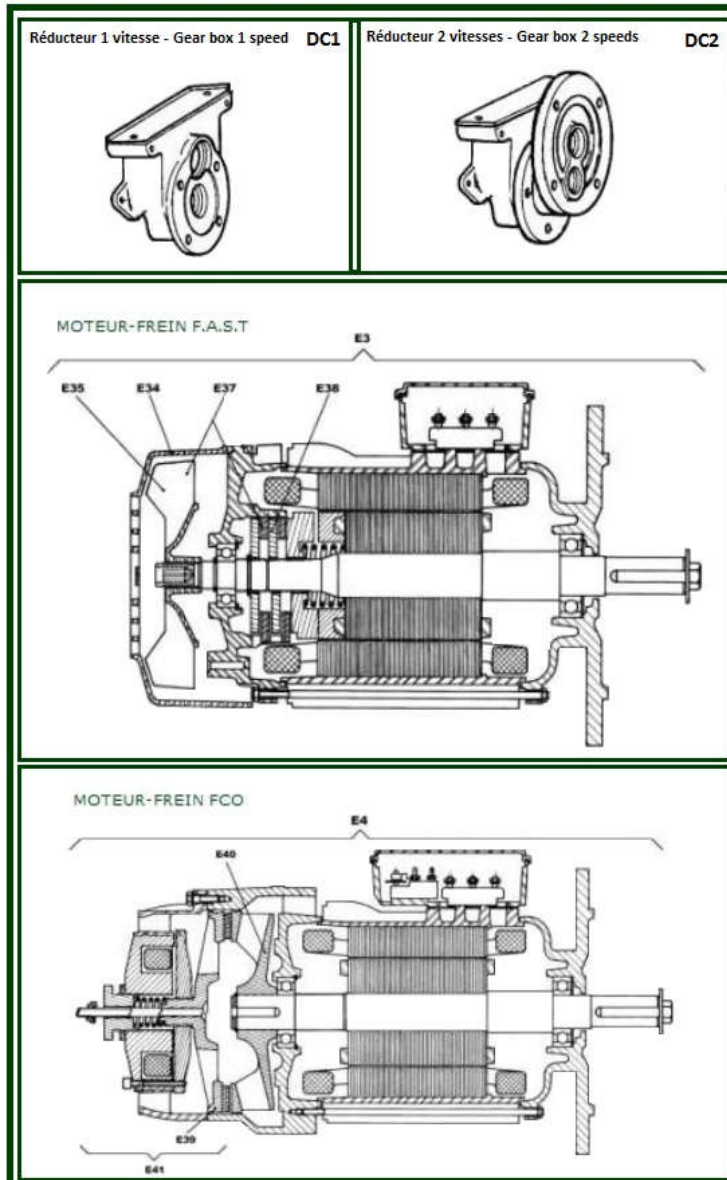

item	reference	description	observation	Quantity
DC1	3444020A	Gear - 20 or 30 m/min - 23 teeth	EA - Birail / Double girder	2
DC1	3434010V	Gear - 20 or 30m / mn - 17 teeth	D - 1 vitesse / speed	2
DC2	3434012X	Gear - 7,5 m/mn or 15 m/mn - 17 teeth	E - 2 vitesses / speeds	2
DC2	3434011W	Gear - 10 or 20/5 m/mn - 17 teeth	D - 2 vitesses / speeds	2
DC2	3444021B	Gear - 30/7,5 m/min - 23 teeth	B	2
DC2	3434013Y	Gear - 40/10 m/min - 17 teeth	F	2
DC2	3444022C	Gear - 40/10 m/min - 23 teeth	C	2
E3	7350271A	Brake motor LS71 FCR 0,37Kw 1500t/mn 220/380V	EA-E - E HPR72 Br/Fl 165/200 - BA/OS 14x30	2
E3	7352401R	Brake motor LS71 FCR 0,55/0.12 Kw 3000t/750/mn 220/380V	EA-E - E HPR72 Br/Fl 165/200 - BA/OS 14x30	2
E3	7352267V	Brake motor LS80 FAST 0,75Kw 1500t/mn 220/380V	EA-E - E HPR72 Br/Fl 165/200 - BA/OS 14x30	2
E3	7352242T	Brake motor LS80 FCO 0,48Kw 1500 t/min 220/380V 50Hz	Plus fourni / No more supplied Br/Fl 165/200 - BA/OS 14x30	2
E3	7352011S	Brake motor LS80 FCR 0,18Kw 750t/mn 220/380V	EA-E - E HPR72 Br/Fl 165/200 - BA/OS 14x30	2
E3	7352177X	Brake motor LS80 FCR 0,55Kw 1000t/mn 220/380V	EA-E - E HPR72 Br/Fl 165/200 - BA/OS 14x30	2

E3	<u>7352271Z</u>	Brake motor LS80 FCR 0,55Kw 1500t/mn 220/380V	EA-E - E HPR72 Br/FI 165/200 - BA/OS 14x30	2
E4	<u>7353407J</u>	Brake motor LS90 FAST 0,48/0,12Kw 3000t/750/mn 220/380V	EA-E - E HPR72 Br/FI 200 - BA/OS 14x30	2
E4	<u>7353461T</u>	Brake motor LS90 FAST 0,75/0,18Kw 3000t/750/mn 220/380V	EA-E - E HPR72 Br/FI 200 - BA/OS 19x40	2
E4	<u>7353403E</u>	Brake motor LS90 FCO 0,75/0,18Kw 3000t/750/min	Br/FI 200 - BA/OS 19x40	2
E34	<u>P80H13FV</u>	Plastic cover LS80 Fast	Plus fourni voir / No more supplied see 990522	1
E34	<u>P90H13FV</u>	Plastic cover LS90 Fast	Plus fourni voir / No more supplied see 990523	1
E34	<u>990522</u>	Steel cover + screw LS80		1
E34	<u>990523</u>	Steel cover + screw LS90		1
E35	<u>P80H15SV</u>	Fan LS80 Fast		1
E35	<u>P90H15SV</u>	Fan LS90 Fast		1
E37	<u>990994</u>	Brake set LS 80 + elastic washer	7+9+10+14+15	1
E37	<u>990995</u>	Brake set LS 90 + elastic washer	3 + 5 + 6 + 10 + 11 Plus fourni / Not supplied	1
E38	<u>990979</u>	Brake discs LS80		2
E38	<u>990980</u>	Brake discs LS90		2
E39	<u>P80H17</u>	Lined brake ring set LS80 FCO		1
E39	<u>18223001</u>	Lined brake ring set LS90 FCO		1
E40	<u>P80H131</u>	Brake disc set LS80 FCO		1
E40	<u>P90H131</u>	Brake disc set LS90 FCO		1
E41	<u>P80HF00</u>	Complete brake LS80 FCO 20V		1
E41	<u>18203001</u>	Complete brake LS90 FCO 20V		1

2.1) DC1

item	reference	description	observation	Quantity
DC1	<u>3444020A</u>	Gear - 20 or 30 m/min - 23 teeth	EA - Birail / Double girder	2
DC1	<u>3434010V</u>	Gear - 20 or 30m / mn - 17 teeth	D - 1 vitesse / speed	2

3) Gearboxes

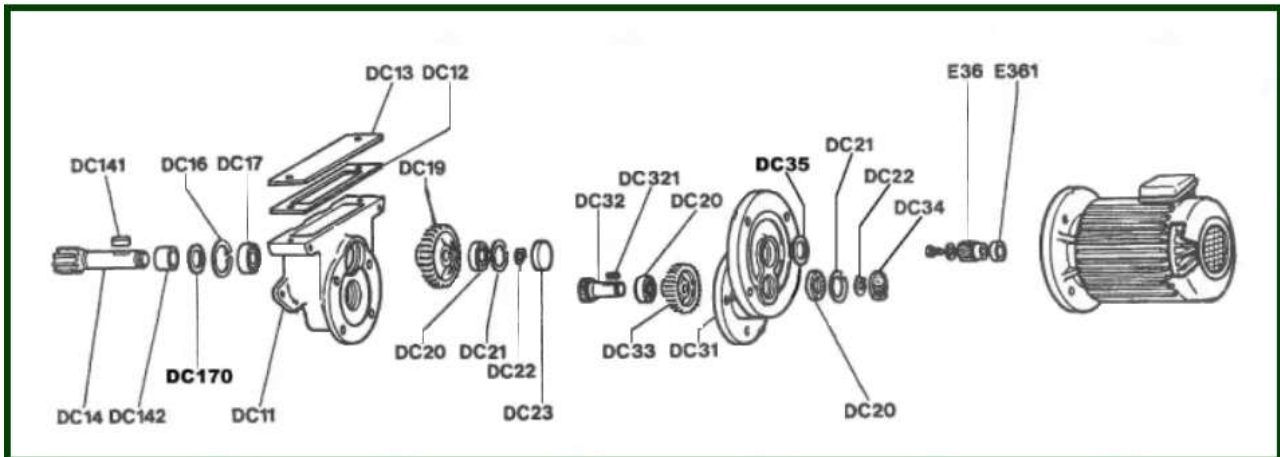

item	reference	description	observation	Quantity
DC11	5434104K	Gear case	1 vitesse / speed	1
DC11	5444101B	Gear case	D	1
DC12	5434103J	Seal		1
DC12	5444103D	Seal	D	1
DC13	5434105L	Cover		1
DC13	5444105F	Cover	D	1
DC14	5434212C	Drive pinion - 17 teeth	Modèle 77	1
DC14	5434211B	Drive pinion - 17 teeth	Seulement pour pont fabriqué avant 1977 Only for crane made before 1977	1
DC14	5444221G	Drive pinion M2 - 23 teeth	A, B, C	1
DC16	300077	Interior circlip	D et DA - I/77 - Ø 47	2
DC17	7412045W	Bearing		1
DC17	7415050N	Bearing	D	1
DC19	5434201R	Gear - 93 teeth		1
DC19	5444201K	Gear - 136 teeth	D	1
DC19	5434202S	Intermediate gear wheel - 87 teeth	F	1
DC19	5444202L	Intermediate gear wheel - 130 teeth	C	1
DC21	7261042N	Interior circlip		12
DC22	830860	Exterior circlip - Ø 20	C2	12
DC23	5434203T	Sealing cap		1
DC31	5444501L	2 speed gearcase	D	1
DC31	5434501S	Gearcase 2 speeds		1
DC32	5434612N	Helical intermediate pinion - 29 teeth	PA 17 dentsC, F	2
DC32	5434611L	Pinion shaft - 23 teeth		2
DC33	5434602B	Gear - 64 teeth	30/7.5 m/mn	1
DC33	5434601A	Gear - 69 teeth	5-10-20/5 m/mn	1
DC34	5434603C	Cover 42		1
DC35	7464510Y	Seal SIMRIT	20 ou 30 m/mn - 5-10 ou 20/5	1
DC141	7281082V	Key	D	1
DC142	5444212X	Pinion collar - 16 teeth	D	1
DC170	7464530V	Seal SIMRIT	D	1
DC321	7282062K	Pinion key - 23 teeth	2 BR 6x6x20	1
E36	5438101E	Motor pinion - 23 teeth	EA-E - E HPR72 - Alésage / Bore 14 - A,D	1
E36	5438102F	Pinion - 32 teeth	Alesage 19 mm	1
E360	7238170B	Alu. washer	17 x 13,4 x 1,5	1
E360	7460710T	Seal SIMRIT	30/7.5 m/mn	1
E361	5438111R	Collar pinion motor - 23 teeth	EA-E - E HPR72 - A,D	1
E361	5438112S	Pinion collar - 32 teeth	EA-E - E HPR72 - B,C,E	1
E362	830010	HM screw 5 x 20		1

E363	<u>5434107P</u>	Breather		1
E363	<u>5434106N</u>	Drain plug		1
E363	<u>7211252T</u>	HM screw 5 x 10		2
E363	<u>7214060V</u>	Travel gearbox fixing screw HM 8 x 50		2
E363	<u>7232050Z</u>	Washer		2

4) Electrical equipment

item	reference	description	observation	Quantity
-	<u>7571404N</u>	Fuse 4A 14 x 51		1
-	<u>7571417B</u>	Fuse 25A 14 x 51		1
-	<u>7512211X</u>	Transformer	220V/380V 2 X 24 V (160VA)	1