

Spare parts catalog for "Endtruck VP"

To avoid errors, when ordering please specify:

- Complete type of hoist
- Date of manufacture and serial number
- Spare part code
- Spare part designation
- Additional information



1) VP9

2) VP11

3) VP14

4) VP20

4.1) VP20 Exploded View

5) VP25 & VPS25

6) VH25 & VH25B

7) VH32 & VH3B

8) MOTOR MF07

9) MOTOR MF09 - SINCE 1994

9.1) Motor MF09L & MF09M - Before 1994

10) MOTORS MF10 - MF11 & MF13

11) GEARBOXES

12) SYNOPTIC

1) VP9

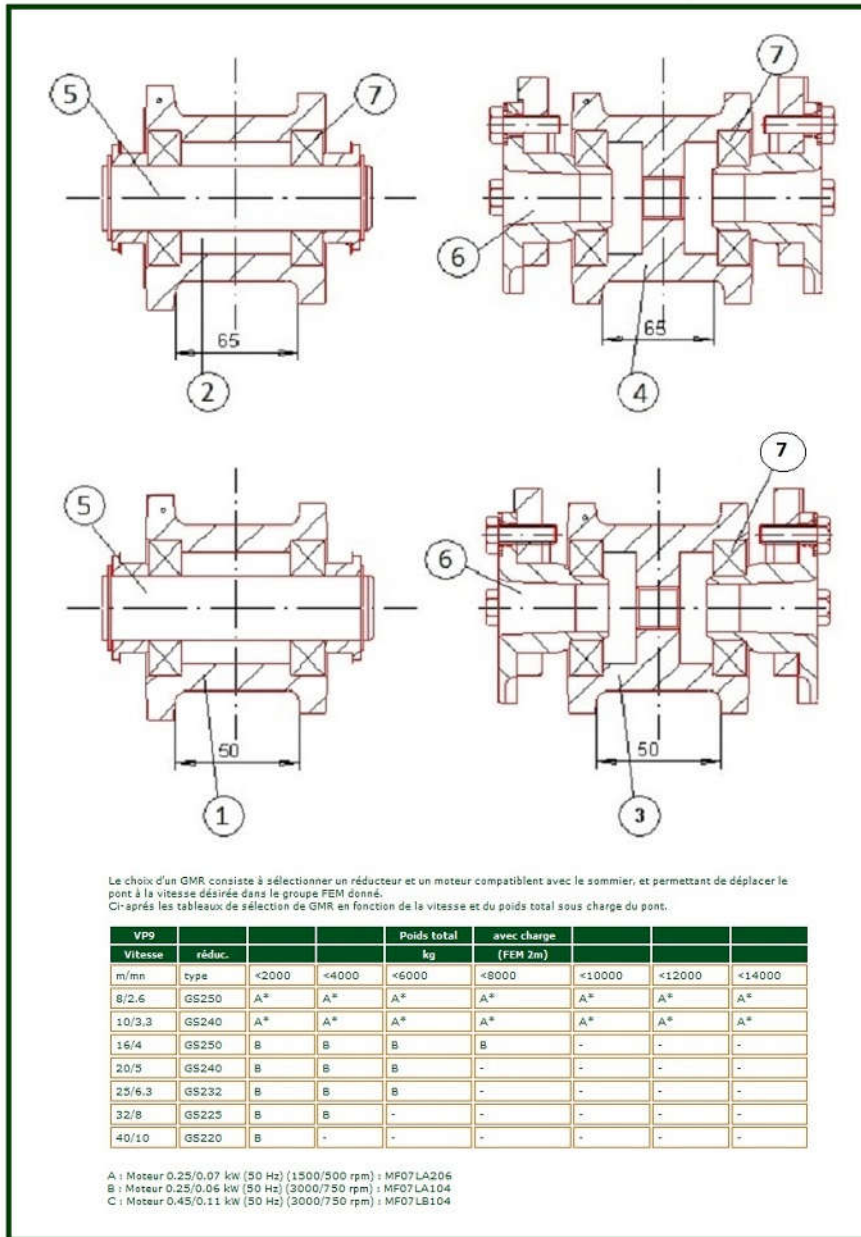

item	reference	description	observation	Quantity
1	15503003	Travel wheel set - ø 90 - G50	VS202/VP9 - VS302..F - VS402 A partir / Since 1999	1
2	15503006	Travel wheel set ø 90 - G65	VS202/VP9 - VS302..F - VS402 A partir / Since 1999	1
3	15503001	Driving wheel set - ø 90 -G50	VS302..F - VS402 A partir / Since 1999	1
4	15503005	Driving wheel set - ø 90 - G65	VS302..F - VS402 A partir / Since 1999	1
5	15503004	Complete shaft travel wheel	VP9	1
6	15503002	Bearling-flange set	VP9-VS302	1
7	7412072A	Complete bearing	VP9-VS302	1

2) VP11

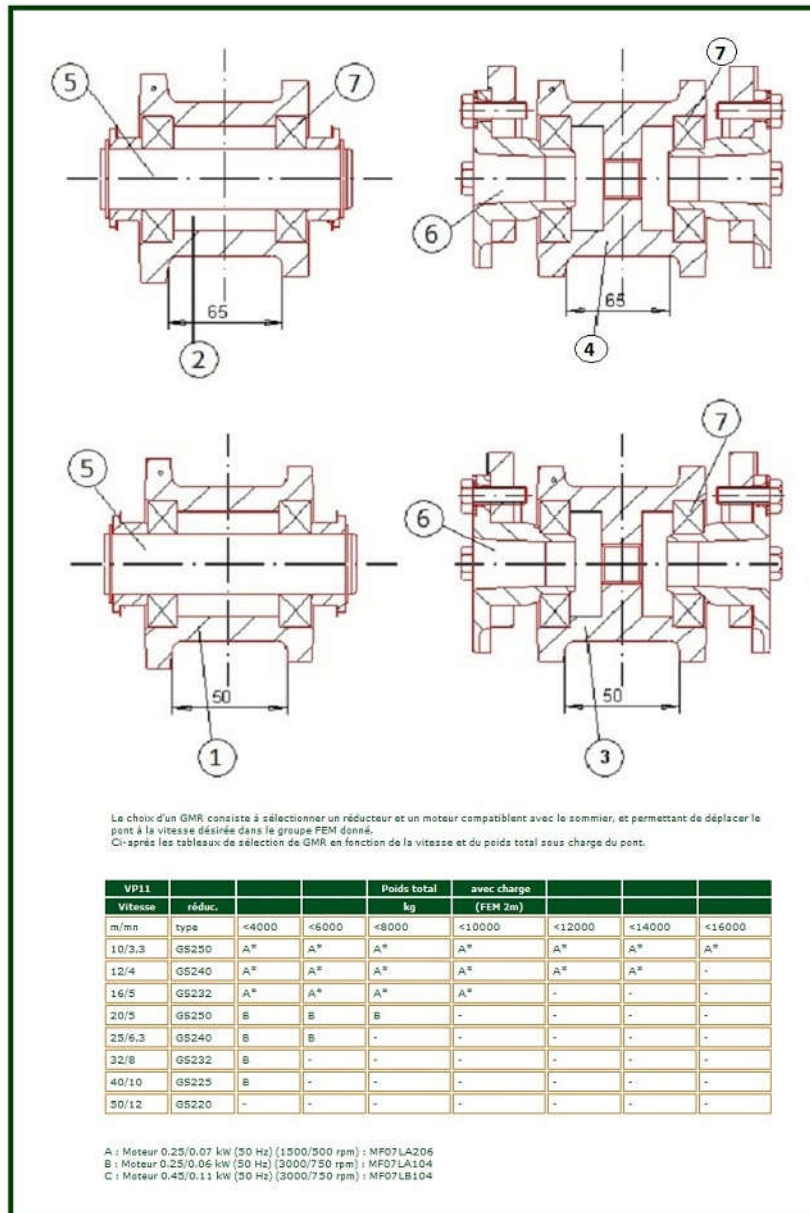

item	reference	description	observation	Quantity
1	15803003	Travel wheel set - ø 110 - G50	VS402 / VP11 - VS204	1
2	15803006	Travel wheel set - ø 110 - G65	VS402 / VP11 - VS204	1
3	15803001	Driving wheel set - ø 110 - G50	VP11 - VS304..F - VS402	1
4	15803005	Driving wheel set - ø 110 - G65	VP11 - VS304..F - VS402	1
5	15803004	Shaft travel wheel	VP11 - VS304 - VS402	1
6	15803002	Bearling-flangeset	VP11 - VS304 - VS402	1
7	7413082Y	Bearing	VP11 - VS304	1

3) VP14

Le choix d'un GMR consiste à sélectionner un réducteur et un moteur compatibles avec le sommier, et permettant de déplacer le pont à la vitesse désirée dans le groupe FEM donné.
Ci-après les tableaux de sélection de GMR en fonction de la vitesse et du poids total sous charge du pont.

VP14				Poids total	avec charge			
Vitesse	réduc.			kg	(FEM Zm)			
m/mn	type	<6000	<8000	<10000	<12000	<14000	<16000	<18000
8/2,6	GS380	A*	A*	A*	A*	A*	A*	A*
10/3,3	GS363	A*	A*	A*	A*	A*	A*	A*
12/4	GS350	A*	A*	A*	A*	A*	A*	-
16/4	GS380	B	B	B	B	C	C	C
20/5	GS363	B	B	C	C	C	C	C
25/6,3	GS350	B	C	C	C	C	4 x C	4 x C
32/8	GS340	C	C	C	C	4 x C	4 x C	4 x C
40/10	GS332	C	C	4 x C	4 x C	4 x C	4 x C	-
50/12	GS325	C	4 x C	4 x C	4 x C	-	-	-
63/16	GS320	4 x C	4 x C	4 x C	-	-	-	-

A : Moteur 0.25/0.07 kW (50 Hz) (1500/500 rpm) : MF07LA206
B : Moteur 0.25/0.06 kW (50 Hz) (3000/750 rpm) : MF07LA104
C : Moteur 0.45/0.11 kW (50 Hz) (3000/750 rpm) : MF07LB104

item	reference	description	observation	Quantity
1	25803003	Travel wheel set - ø 140 - G50	VS404 / VP14 VS502 VS504 < 16T	1
3	25803006	Travel wheel set - ø 140 - G65	VS404 / VP14 VS502 VS504 < 16T	1
5	25803001	Driving wheel set - ø 140 - G50	VS404 / VP14 - VS502 VS504 < 16T	1
6	25803005	Driving wheel set - ø 140 - G65	VS404 / VP14 - VS502 VS504 < 16T	1
11	25803007	Shaft travel wheel	VP14 - VS404 - VS502 - VS504 < 16T	1
13	25803002	Bearing flange set	VP14 - VS404 - VS502 - VS504 < 16T	1
14	7412112U	Bearing compl.	VP14 - VS404 - VS502 - VS504 < 16T	1

4) VP20

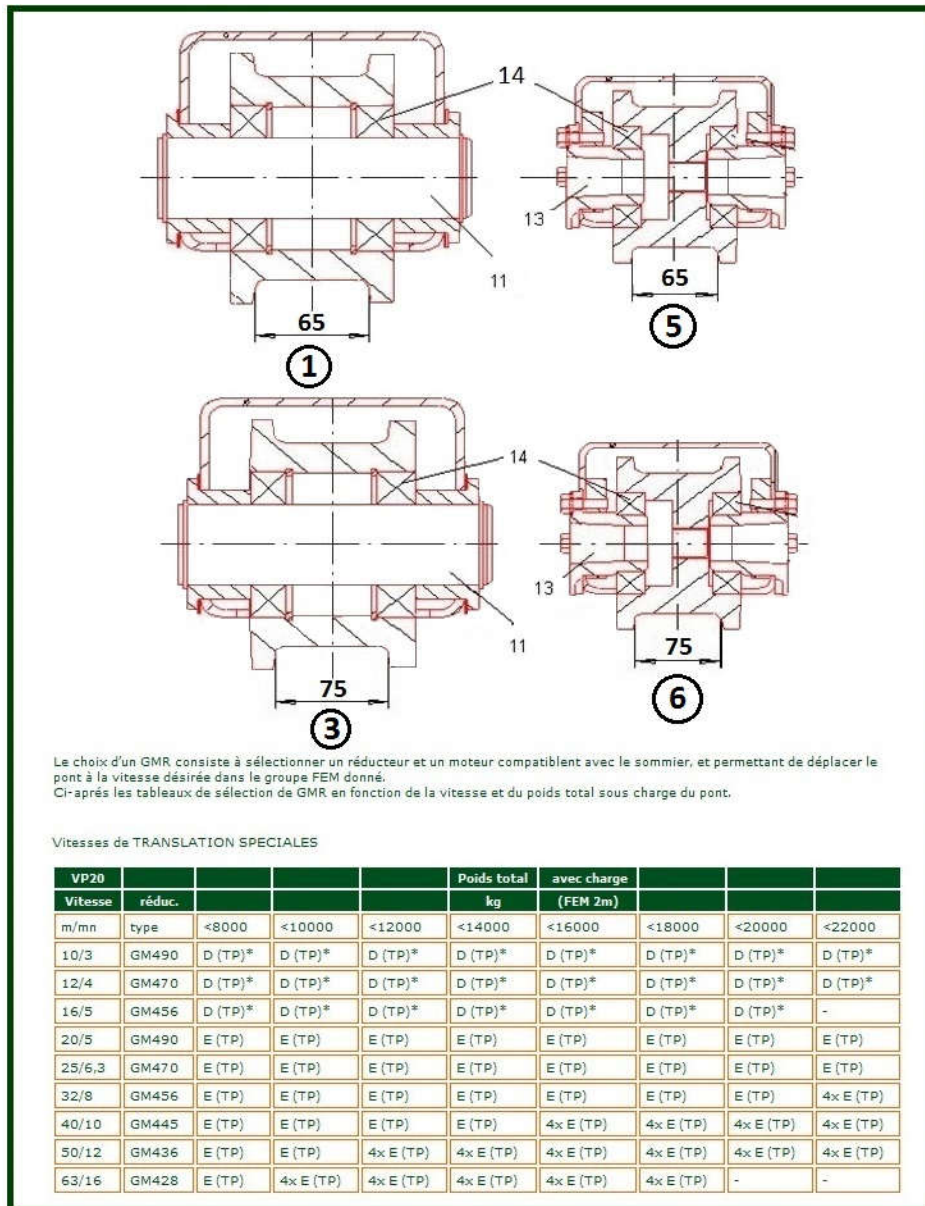

item	reference	description	observation	Quantity
1	35803003	Travel wheel set - Ø 200 - G65	VS502/VS504 < 16t	1
3	35803006	Travel wheel set - Ø 200 - G75	VS502/VS504 < 16t	1
5	35803001	Driving wheel set - Ø 200 - G65	VS502/VS504 < 16t	1
6	35803005	Driving wheel set - Ø 200 - G75	VS502/VS504 < 16t	1
11	35803004	Idle shaft set	VS5 - XS5	1
13	35803002	Geared shaft set	VS5 - XS5	1
14	7413122A	Bearing	VS504 VP20	1
-	7911001Q	Buffer set - Ø 100		4
-	35803008	Motorgearbox fixings	GM4	2
-	35803007	Support arm assy		2

4.1) VP20 Exploded View

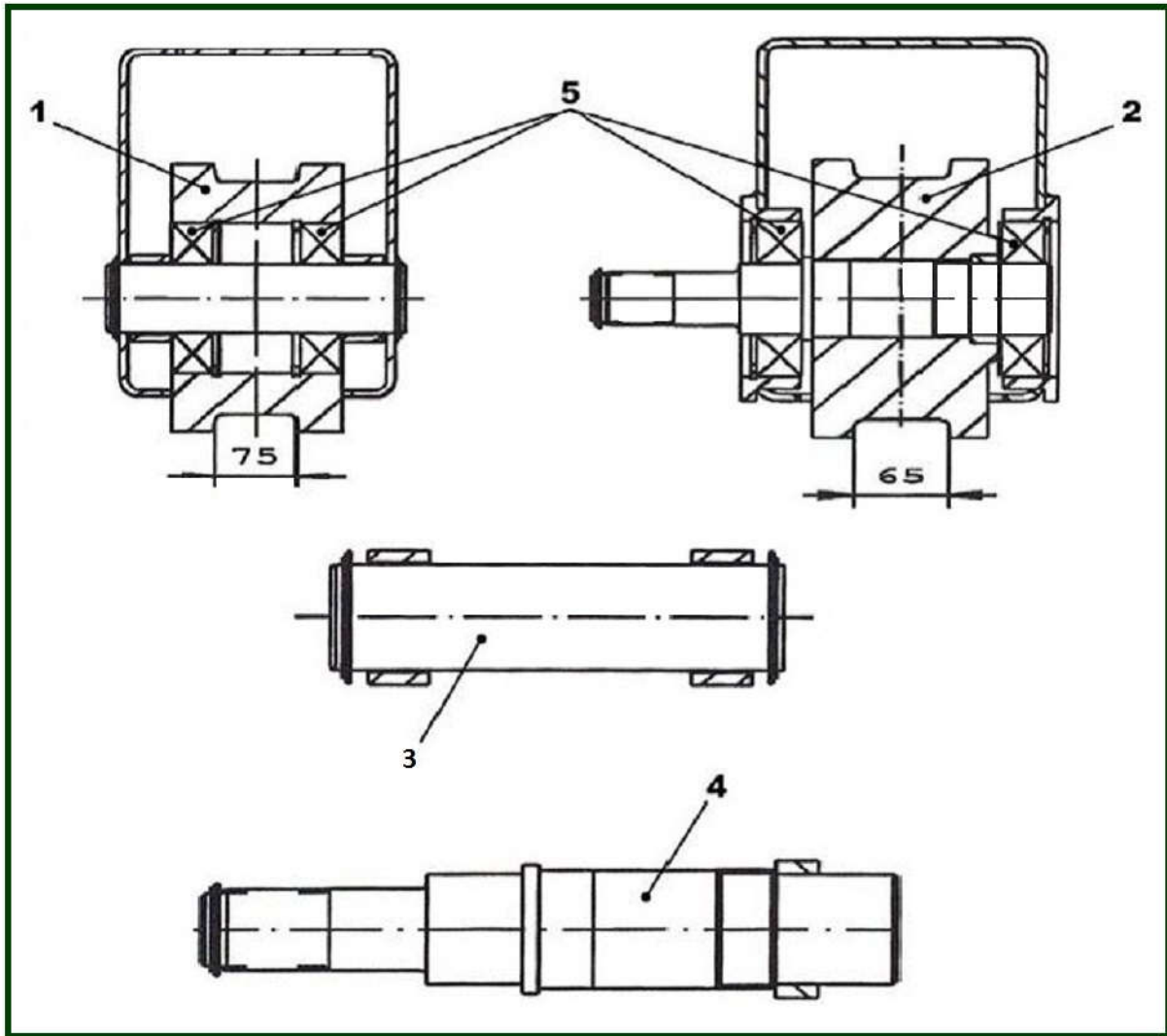

item	reference	description	observation	Quantity
1	35803001	Driving wheel set - Ø 200 - G65	VS502/VS504 < 16t	2
1	35803003	Travel wheel set - Ø 200 - G65	VS502/VS504 < 16t	2
1	35803006	Travel wheel set - Ø 200 - G75	VS502/VS504 < 16t	2
2	35803005	Driving wheel set - Ø 200 - G75	VS502/VS504 < 16t	2
3	35803004	Idle shaft set	VS5 - XS5	2
4	35803002	Geared shaft set	VS5 - XS5	2
5	7412070M	Bearing	VS5 - XS5	8

5) VP25 & VPS25

VP25				Poids total		avec charge			
Vitesse	réduc.			kg		(FEM 2m)			
m/mn	type	<12000	<14000	<16000	<18000	<20000	<22000	<25000	
12/4	GM490	D (TP)*	D (TP)*	D (TP)*	D (TP)*	D (TP)*	D (TP)*	D (TP)*	
16/5	GM470	D (TP)*	D (TP)*	D (TP)*	D (TP)*	D (TP)*	D (TP)*	4x D (TP)*	
20/6,3	GM456	D (TP)*	D (TP)*	D (TP)*	D (TP)*	4x D (TP)*	4x D (TP)*	4x D (TP)*	
25/6,3	GM490	E (TP)	E (TP)	E (TP)	E (TP)	E (TP)	E (TP)	E (TP)	
32/8	GM470	E (TP)	E (TP)	E (TP)	E (TP)	E (TP)	4x E (TP)	4x E (TP)	
40/10	GM456	E (TP)	E (TP)	E (TP)	4x E (TP)	4x E (TP)	4x E (TP)	4x E (TP)	
50/12	GM445	E (TP)	4x E (TP)	4x E (TP)	4x E (TP)	4x E (TP)	4x E (TP)	4x E (TP)	
63/16	GM436	4x E (TP)	4x E (TP)	4x E (TP)	4x E (TP)	4x E (TP)	-	-	
80/20	GM428	4x E (TP)	4x E (TP)	4x E (TP)	-	-	-	-	

VPS25				Poids total		avec charge			
Vitesse	réduc.			kg		(FEM 2m)			
m/mn	type	<20000	<25000	<30000	<35000	<40000	<45000	<50000	<55000
12/4	GM590	F* (TP)	F* (TP)	F* (TP)	F* (TP)	F* (TP)	F* (TP)	F* (TP)	-
16/5	GM570	F* (TP)	F* (TP)	F* (TP)	F* (TP)	G* (TPST)	G* (TPST)	G* (TPST)	G* (TPST)
20/6,3	GM556	F*	F*	F*	G* (TPST)	G* (TPST)	G* (TPST)	G* (TPST)	G* (TPST)
25/6,3	GM590	H (TP)	H (TP)	H (TP)	H (TP)	H (TP)	H (TP)	H (TP)	-
32/8	GM570	H (TP)	H (TP)	H (TP)	H (TP)	H (TP)	I (TPST)	I (TPST)	I (TPST)
40/10	GM556	H (TP)	H (TP)	H (TP)	I (TP)	I (TP)	I (TP)	I (TP)	J (TPST)
50/12	GM545	H	H	I (TP)	I (TP)	I (TP)	J (TP)	J (TP)	J (TP)
63/16	GM536	H	I (TP)	I (TP)	J (TP)	J (TP)	J (TP)	4x J (TP)	4x J (TP)
80/20	GM528	I (TP)	I (TP)	J (TP)	J (TP)	4x J (TP)	4x J (TP)	4x J (TP)	4x J (TP)
100/25	GM522	J (TP)	J (TP)	J (TP)	4x J (TP)	4x J (TP)	4x J (TP)	4x J (TP)	4x J (TP)

D : Moteur 0.37/0.1 kW (50 Hz) (1500/500 rpm) : MF07ZB206
E : Moteur 0.65/0.15 kW (50 Hz) (3000/750 rpm) : MF07ZC104

6) VH25 & VH25B

VH25				Poids total	avec charge		
Vitesse	réduc.			kg	(FEM 2m)		
m/mn	type	<35000	<40000	<45000	<50000	<55000	<60000
12/4	GM590	F* (TP)	F* (TP)	F* (TP)	F* (TP)	-	-
16/5	GM570	F* (TP)	G* (TPST)	G* (TPST)	G* (TPST)	G* (TPST)	G* (TPST)
20/6,3	GM556	G* (TPST)	G* (TPST)	G* (TPST)	G* (TPST)	G* (TPST)	-
25/6,3	GM590	H (TP)	H (TP)	H (TP)	H (TP)	-	-
32/8	GM570	H (TP)	H (TP)	I (TPST)	I (TPST)	I (TPST)	I (TPST)
40/10	GM556	I (TP)	I (TP)	I (TP)	I (TP)	J (TPST)	J (TPST)
50/12	GM545	I (TP)	I (TP)	J (TP)	J (TP)	J (TP)	4x J (TP)
63/16	GM536	I (TP)	J (TP)	J (TP)	4x J (TP)	4x J (TP)	4x J (TP)
80/20	GM528	J (TP)	4x J (TP)	4x J (TP)	4x J (TP)	4x J (TP)	4x J (TP)
100/25	GM522	4x J (TP)	4x J (TP)	4x J (TP)	4x J (TP)	4x J (TP)	-

VH25B				Poids total	avec charge		
Vitesse	réduc.			kg	(FEM 2m)		
m/mn	type	<70000	<80000	<90000	<100000	<110000	<120000
12/4	GM590	4x F* (TP)	4x F* (TP)	4x F* (TP)	4x F* (TP)	-	-
16/5	GM570	4x F* (TP)	4x G* (TPST)	4x G* (TPST)	4x G* (TPST)	4x G* (TPST)	4x G* (TPST)
20/6,3	GM556	4x G* (TPST)	4x G* (TPST)	4x G* (TPST)	4x G* (TPST)	4x G* (TPST)	-
25/6,3	GM590	4x H (TP)	4x H (TP)	4x H (TP)	4x H (TP)	-	-
32/8	GM570	4x H (TP)	4x H (TP)	4x I (TPST)	4x I (TPST)	4x I (TPST)	4x I (TPST)
40/10	GM556	4x I (TP)	4x I (TP)	4x I (TP)	4x I (TP)	4x J (TPST)	4x J (TPST)
50/12	GM545	4x I (TP)	4x I (TP)	4x J (TP)	4x J (TP)	4x J (TP)	-
63/16	GM536	4x I (TP)	4x J (TP)	4x J (TP)	-	-	-
80/20	GM528	4x J (TP)	-	-	-	-	-
100/25	GM522	-	-	-	-	-	-

F : Moteur 0.65/0.15 kW (50 Hz) (1500/500 rpm) : MF09LB206
 G : Moteur 1.1/0.35 kW (50 Hz) (1500/500 rpm) : MF10L-206
 H : Moteur 1.3/0.3 kW (50 Hz) (3000/750 rpm) : MF09LB104
 I : Moteur 2.2/0.55 kW (50 Hz) (3000/750 rpm) : MF10L-104
 J : Moteur 3/0.75 kW (50 Hz) (3000/750 rpm) : MF11LB104
 * : moteur 1500/500 tr/mn
 TP : passage PV sur 2 phases
 TPST : idem TP + démarrage doux
 (standard : 2 moteurs / paire de sommiers)

7) VH32 & VH3B

VH32					Poids total	avec charge		
Vitesse	réduc.				kg	(FEM 2m)		
m/mn	type	<35000	<40000	<45000	<50000	<55000	<60000	
16/5	GM590	F* (TP)	F* (TP)	-	-	-	-	
20/6,3	GM570	F* (TP)	G* (TPST)	G* (TPST)	G* (TPST)	G* (TPST)	G* (TPST)	
25/8	GM556	G* (TPST)	G* (TPST)	G* (TPST)	-	-	-	
32/8	GM590	H (TP)	H (TP)	H (TP)	-	-	-	
40/10	GM570	H (TP)	I (TPST)	I (TPST)	I (TPST)	I (TPST)	I (TPST)	
50/12	GM556	I (TP)	I (TP)	I (TP)	J (TPST)	J (TPST)	J (TPST)	
63/16	GM545	I (TP)	J (TP)	J (TP)	J (TP)	4x J (TP)	4x J (TP)	
80/20	GM536	J (TP)	J (TP)	4x J (TP)	4x J (TP)	4x J (TP)	4x J (TP)	
100/25	GM528	4x J (TP)	4x J (TP)	4x J (TP)	4x J (TP)	4x J (TP)	4x J (TP)	

VH32B					Poids total	avec charge		
Vitesse	réduc.				kg	(FEM 2m)		
m/mn	type	<70000	<80000	<90000	<100000	<110000	<120000	
16/5	GM590	4x F* (TP)	4x F* (TP)	-	-	-	-	
20/6,3	GM570	4x F* (TP)	4x G* (TPST)	4x G* (TPST)	4x G* (TPST)	4x G* (TPST)	4x G* (TPST)	
25/8	GM556	4x G* (TPST)	4x G* (TPST)	4x G* (TPST)	-	-	-	
32/8	GM590	4x H (TP)	4x H (TP)	4x H (TP)	-	-	-	
40/10	GM570	4x H (TP)	4x I (TPST)	4x I (TPST)	4x I (TPST)	4x I (TPST)	4x I (TPST)	
50/12	GM556	4x I (TP)	4x I (TP)	4x I (TP)	4x J (TPST)	4x J (TPST)	4x J (TPST)	
63/16	GM545	4x I (TP)	4x J (TP)	4x J (TP)	4x J (TP)	-	-	
80/20	GM536	4x J (TP)	4x J (TP)	-	-	-	-	
100/25	GM528	-	-	-	-	-	-	

F : Moteur 0,65/0,15 kW (50 Hz) (1500/500 rpm) : MF09LB206
 G : Moteur 1,1/0,35 kW (50 Hz) (1500/500 rpm) : MF10L-206
 H : Moteur 1,3/0,3 kW (50 Hz) (3000/750 rpm) : MF09LB104
 I : Moteur 2,2/0,55 kW (50 Hz) (3000/750 rpm) : MF10L-104
 J : Moteur 3/0,75 kW (50 Hz) (3000/750 rpm) : MF11LB104
 * : moteur 1500/500 tr/mn
 TP : passage PV sur 2 phases
 TPST : idem TP + démarrage doux
 (standard : 2 moteurs / paire de sommiers)

8) Motor MF07

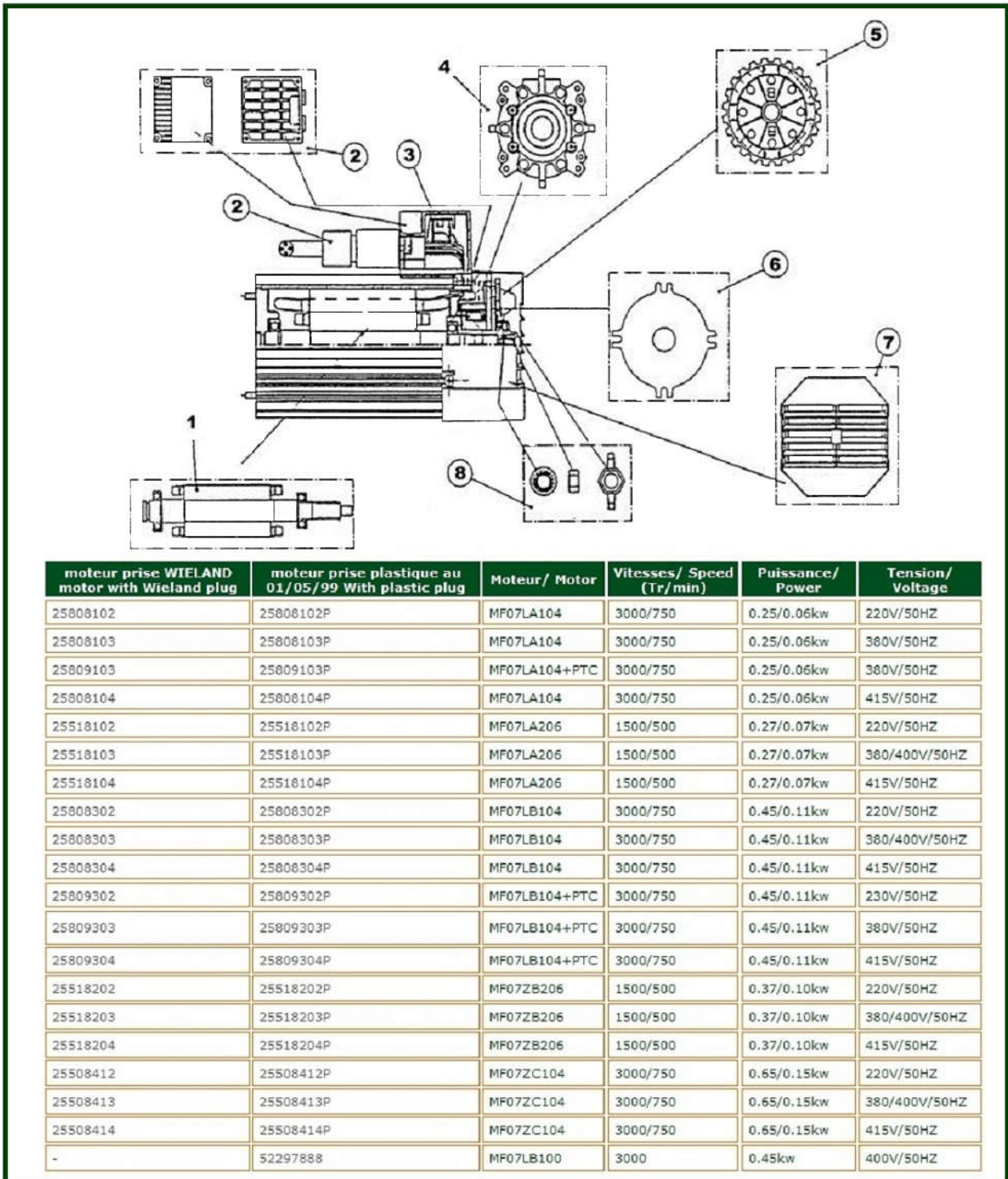

item	reference	description	observation	Quantity
2	15822002	Complete connecting box		1
2	15522001	Complete connecting box plastic		1
2	52298744	Complete connecting box q plug	Moteur MF07 depuis 2002 MF07 motor since 2002	1
2	1113211	Female Plastic socket	Pour tous les moteurs MF07 / for all the motor MF07	1
3	15823006	Rectifier	Moteur / Motor 380 à 550V	1
3a	15823007	Rectifier	Moteur / Motor 220V	1
4	15823001	Brake coil with holder	170V	1
5	15823004	Brake wheel with friction material		1

6	<u>15823003</u>	Fixed braking armature		1
7	<u>15822001</u>	Fan cover		1
8	<u>15823005</u>	Brake disc locking set		1
11	<u>15823002</u>	Brake spring	MF07LA104/2NM : qty 3 MF07LA206/2.6NM : qty 4 MF07LB104/2.6NM : qty 4 MF07ZC104/4NM : qty 6 MF07S104/2NM : qty 3	1

9) MOTOR MF09 - since 1994

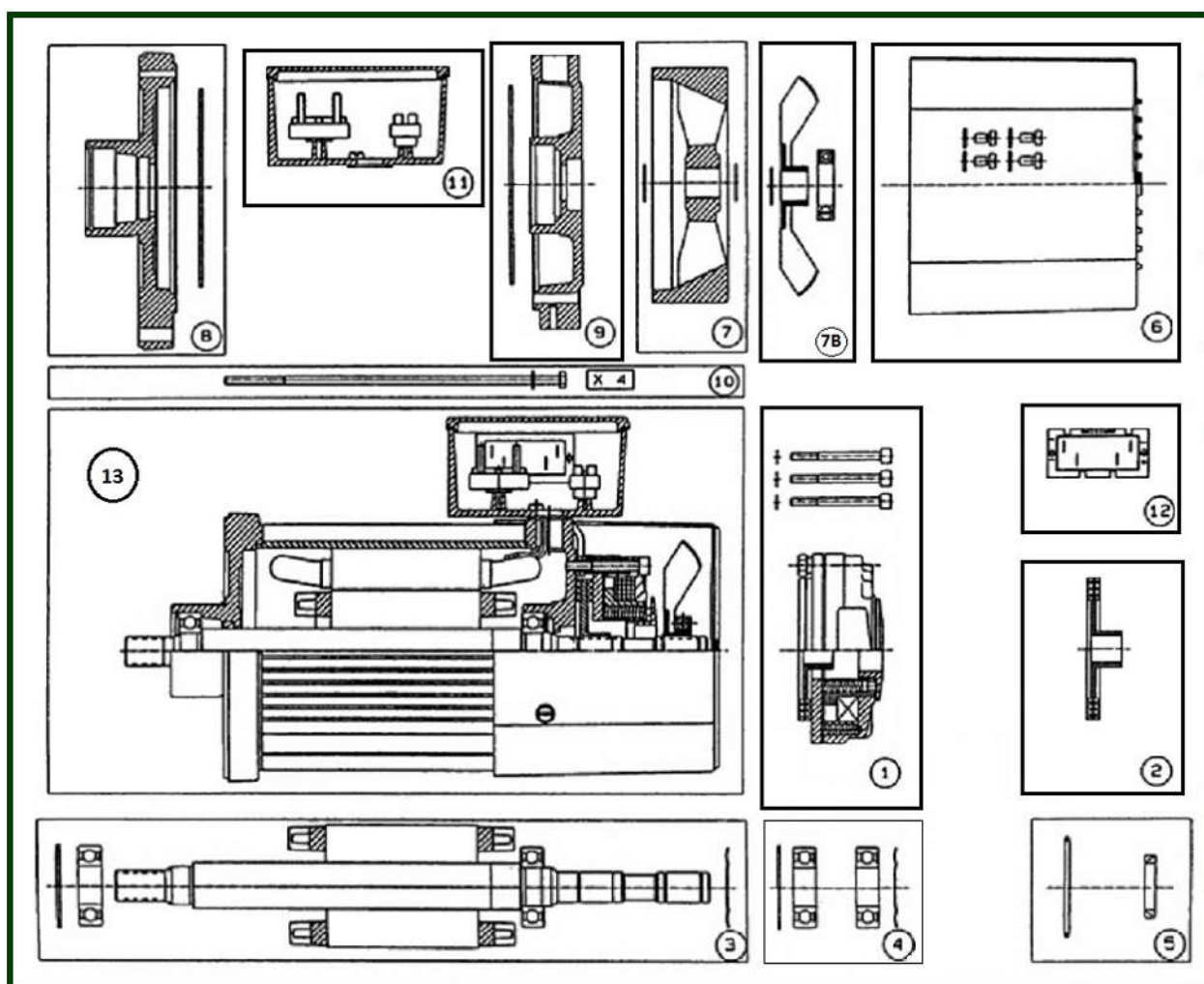

item	reference	description	observation	Quantity
1	25808435	Complete brake 9NM LB104/LB206	Frein 100V pour moteur	1
1	25808433	Complete brake 9NM LB104/LB206	Frein 220V pour moteur 500V	1
1	25808434	Complete brake 9NM LB104/LB206	Frein 290V pour moteur 660V / Brake 290V for motor 660 V	1
1	25808419	Complete brake 16NM	Frein 170V	1
1	25808432	Complete brake 9NM LB104/LB206MF07ZC-190V	Frein/Brake 190V - Motor 220V	1
1	25808431	Complete brake 9NM LB104/LB206-MF07ZC 100V	Frein/Brake 170V - Motor 280/400V	1
1	25808535	Complete brake LA104/LA206	Frein 100V pour moteur	1
1	25808531	Complete brake LA104/LA206	Frein 170V pour moteur 380/400V	1
1	25808532	Complete brake LA104/LA206	Frein 190V pour moteur 220V	1
1	2580853	Complete brake LA104/LA206	Frein 220V pour moteur 500V	1
1	25808534	Complete brake LA104/LA206	Frein 290V pour moteur 660V	1
2	25808411	Brake wheel	Brake wheel n°354415	1
2	25808413	Brake wheel	Frein / Brake 4 & 9NM	1
2	25808414	Brake wheel (MF09)	Frein 16NM Brake 16NM	1
3	25808436	Complete rotor	NC	1
4	25808437	Bearing set	NC	1
5	25808438	Shaft seal	NC	1
6	25808439	Fan cover		1
7	25808440	Flywheel	MF09LB068 à 073 MF09L-102	1
7b	25808441	Fan	MF09LA050 à 54 MF09LN062 à 067	1
8	25808442	Front flange		1

9	<u>25808443</u>	End shield		1
10	<u>25808444</u>	Screw set		1
11	<u>25808445</u>	Connecting vox		1
12	<u>15823007</u>	Rectifier	Moteur / Motor 220V	1
12	<u>15823006</u>	Rectifier	Moteur / Motor 380 à 550V	1
13	<u>25808505</u>	Motor	MF09LA04-3000/750-0,65/0,15KW-380/400V/50HZ	1
13	<u>25519413</u>	Motor	MF09LA20+PTC-1500/500-0,30/0,07KW-380/400V/50HZ	1
13	<u>25809405</u>	Motor	MF09LB100+PTC-3000-1,8KW-380/400V/50HZ	1
13	<u>25808402</u>	Motor	MF09LB104-3000/750-1,3/0,3KW-220V/50HZ	1
13	<u>25808405</u>	Motor	MF09LB104-3000/750-1,3/0,3KW-380/400V/50HZ	1
13	<u>25518422</u>	Motor	MF09LB206-1500/500-0,65/0,15KW-220V/50HZ	1
13	<u>25518423</u>	Motor	MF09LB206-1500/500-0,65/0,15KW-380/400V/50HZ	1
13	<u>25518424</u>	Motor	MF09LB206-1500/500-0,65/0,15KW-415V/50HZ	1
-	<u>NC</u>	Perpendiculaire Retainer	C5	1

9.1) Motor MF09L & MF09M - Before 1994

MOTEUR / Motor MF09M14 (avant 1994/before 1994) Moteur MF09M14 plus fourni remplacer les 2 motoréducteurs avec moteur MF07... MF09M14
motor not supplied anymore to be replaced by MF07... motors

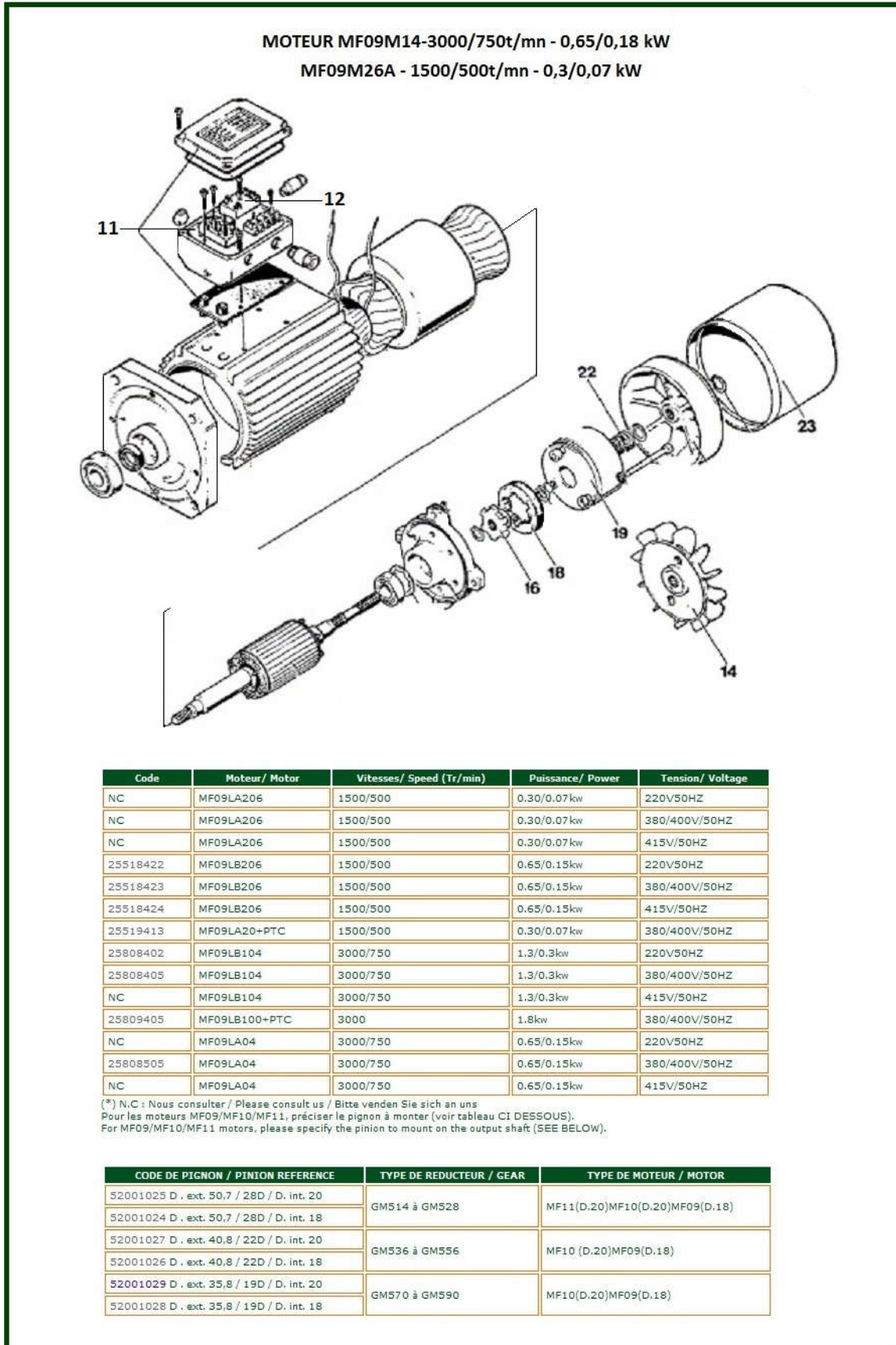

item	reference	description	observation	Quantity
11	25808445	Connecting vox		1

12	<u>15823007</u>	Rectifier	Moteur / Motor 220V	1
12	<u>15823006</u>	Rectifier	Moteur / Motor 380 à 550V	1
14	<u>8048</u>	Plastic fan		1
16	<u>8046</u>	Hub Brake lining		1
16+18+19	<u>52301835</u>	Brake KEB 170V	Arbre cannelé moteur n°3-400V - Splined shaft/motor n°3-400V	1
16+18+19	<u>50011528</u>	Brake KEB 190V	MF09M	1
18	<u>35823004</u>	Brake lining		1
22	<u>35823002</u>	Brake spring		1
23	<u>35822001</u>	Cover		1

10) MOTORS MF10 - MF11 & MF13

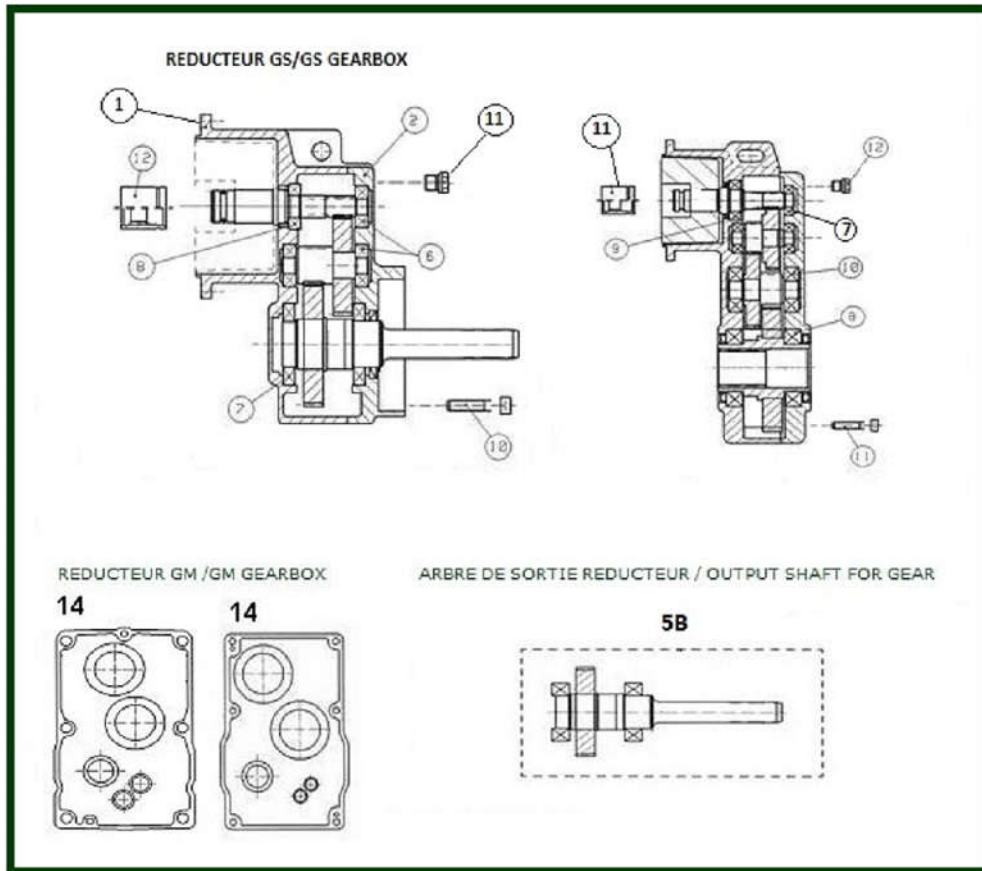

item	reference	description	observation	Quantity
-	25808415	Brake disk		1
-	25808420	Complete brake MF10	Frein/Brake 190V	1
-	25808421	Complete brake MF11	Frein/Brake 170V	1
-	25808416	D3 brake disc	Seulement pour moteur avec frein manuel d'origine 30 & 60NM / Only for motor with original manual brake 30 & 60NM	1
-	25808417	D4 brake disc	Seulement pour moteur avec frein manuel d'origine / Only for motor with origin manual brake	1
-	15823007	Rectifier	Moteur / Motor 220V	1
-	15823006	Rectifier	Moteur / Motor 380 à 550V	1

11) Gearboxes

De / From 1990 to 2002

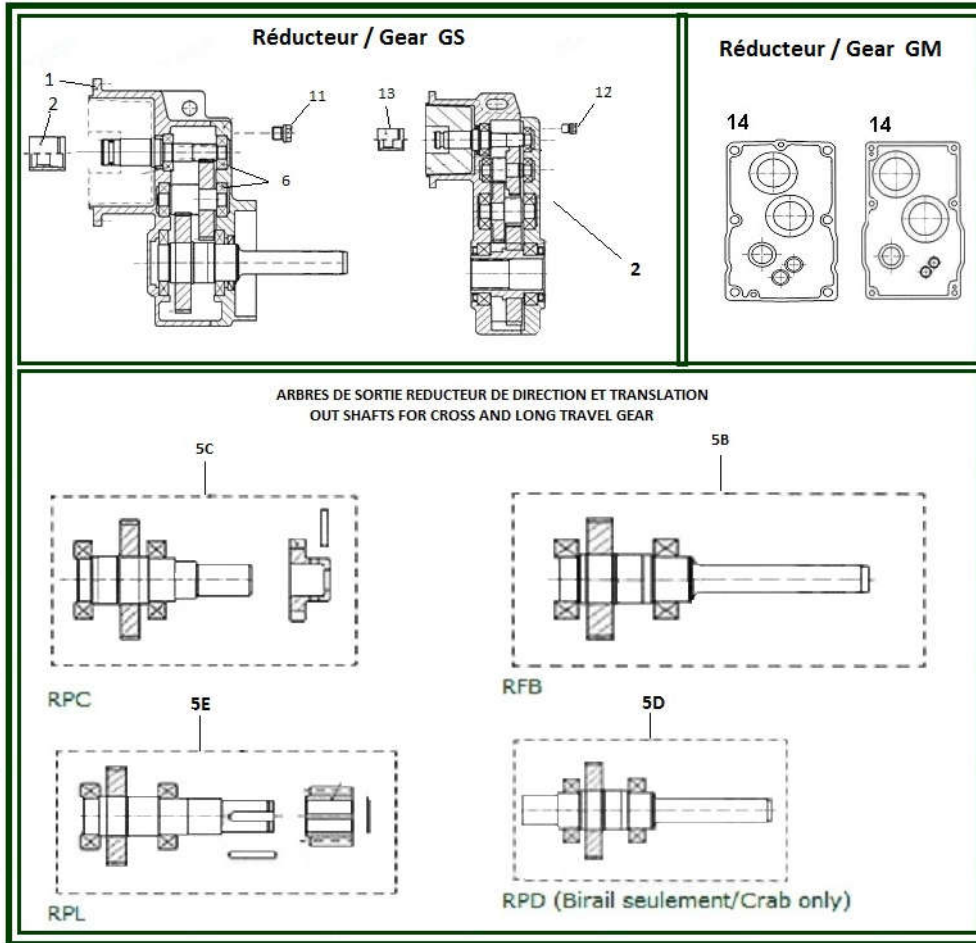

item	reference	description	observation	Quantity
1	25882060	Gear GS 215 RFB		1
1	25882050	Gear GS 220 RFB		1
1	25882040	Gear GS 225 RFB		1
1	1147201	Gear GS 232 RPD		1
1	25882020	Gear GS 240 RFB		1
1	1147202	Gear GS 240 RPD		1
1	1147203	Gear GS 250 RBF		1
1	25882010	Gear GS 250 RFB		1
1	25882030	Gear GS 323 RFB		1
1	25883070	Gear GS 330 RFB		1
1	25883050	Gear GS 332 RFB		1
1	25883040	Gear GS 340 RFB		1
1	25883060	Gear GS 350 RFB		1
1	25883030	Gear GS 350 RFB		1
1	25883020	Gear GS 363 RFB		1
1	25883010	Gear GS 380 RBF		1
2	25543660	Cross travel gearbox GM 436 MPB		1
2	25544550	Cross travel gearbox GM 445 MPB		1
2	25545640	Cross travel gearbox GM 456 MPB		1
2	25547030	Cross travel gearbox GM 470 MPB		1
2	25549020	Cross travel gearbox GM 490 MPB		1
12&13	PIG0005	Coupling	VS1 N1	1
14	35503403	Sealing set	GM4	1
14	15803206	Set of Sealing	Réducteur / Gear GS2-GS3	1
-	35803008	Motorgearbox fixings	GM4	1
-	35503402	Set of bearings	GM4	1
-	15803204	Set of bearings	Réducteur / Gear GS 313-315-320-325-332 RPL	1
-	15803205	Set of bearings	Réducteur / Gear GS 340 RPL	1

12) Synoptic

